

Memo

Date 11 January 2022

To: Celia Davison Manager Planning – Central South
 From: Bronnie Styles, Auckland wide Planning Technician

Subject: Plan Modification: Clause 20A modification to Auckland Unitary Plan

Corrections are required to the Auckland Unitary Plan (Operative in Part) 2016 (the AUP).





I seek your approval of this plan modification pursuant to clause 20A, first schedule, Resource Management Act 1991.

You have delegated authority, as a tier four manager, to make a decision to correct an error to an operative plan under clause 20A. Schedule 2A of the Auckland Council Combined Chief Executives Delegation Register¹ authorises all powers, functions, and duties under RMA's first schedule (except clause 17 which cannot be delegated) to tier four positions.

Rule or Section of Unitary Plan	Chapter K Designations <ul style="list-style-type: none"> • Auckland Transport GIS Viewer
Subject Site (if applicable)	n/a
Legal Description (if applicable)	n/a
Nature of change	<p>A Clause 20A modification is required to correct Chapter K Designations and the GIS Viewer in the AUP.</p> <p>Discussion In accordance with section 184 of the Resource Management Act (the Act), designations lapse five years after being included in the plan unless the designation has been given effect to or the designation specified a different period when incorporated into the plan.</p> <p>A requiring authority may, within three months before the expiry of lapse date, request Auckland Council to fix the lapse date for a longer period for designations which have not been given effect to.</p> <p>Auckland Council wrote to all requiring authorities requesting :</p> <ol style="list-style-type: none"> 1. Confirmation as to whether any designations due to expire in 2021 have either been given effect to and if not whether a longer lapse period is required. <p>Where a longer lapse period is required, a section 184 application needs to be lodged with Auckland Council. The application is required to include</p>

	<p>the reasons for a longer lapse date and show that substantial progress or effort has been made towards giving effect to the designation and is continuing to be made (section 184(2)(b)).</p> <p>2. That they review and confirm whether the information of each designation was correct.</p>																														
<p>Effect of change</p>	<p>These changes are minor in nature. The amendments do not change the application or intent of the provisions.</p> <p>There is no effect nor impact upon either the environment or the person.</p>																														
<p>Changes required to be made (text/in-text diagrams)</p>	<p>Amend Chapter K Designations, Auckland Transport in the Operative in Part version.</p> <p>Remove the below lapsed designations from Chapter K Designations Auckland Transport</p> <table border="1" data-bbox="416 918 1404 1344"> <thead> <tr> <th>Designation number</th> <th>Scheme name</th> <th>Address</th> <th>Area</th> <th>Purpose</th> </tr> </thead> <tbody> <tr> <td>1403</td> <td>Red Beach Road</td> <td>55-67 and 76-90 Red Beach Road, Whangaparaoa</td> <td>North</td> <td>Road widening</td> </tr> <tr> <td>1446</td> <td>Birdwood Road</td> <td>98 Birdwood Road and 39-59 Bradnor Meadows Drive, Ranui</td> <td>West</td> <td>Road widening</td> </tr> <tr> <td>1450</td> <td>Lincoln Road</td> <td>6-8, 14, 122-134, 211-221 Lincoln Road and 1-3 Swanson Road, Henderson</td> <td>West</td> <td>Road widening</td> </tr> <tr> <td>1800</td> <td>Ormiston Road</td> <td>542 and 568 Ormiston Road, Flat Bush</td> <td>East / South</td> <td>Road widening</td> </tr> <tr> <td>1801</td> <td>Kerr Road</td> <td>1 Kerr Road, Manukau City Centre</td> <td>East / South</td> <td>Road widening</td> </tr> </tbody> </table>	Designation number	Scheme name	Address	Area	Purpose	1403	Red Beach Road	55-67 and 76-90 Red Beach Road, Whangaparaoa	North	Road widening	1446	Birdwood Road	98 Birdwood Road and 39-59 Bradnor Meadows Drive, Ranui	West	Road widening	1450	Lincoln Road	6-8, 14, 122-134, 211-221 Lincoln Road and 1-3 Swanson Road, Henderson	West	Road widening	1800	Ormiston Road	542 and 568 Ormiston Road, Flat Bush	East / South	Road widening	1801	Kerr Road	1 Kerr Road, Manukau City Centre	East / South	Road widening
Designation number	Scheme name	Address	Area	Purpose																											
1403	Red Beach Road	55-67 and 76-90 Red Beach Road, Whangaparaoa	North	Road widening																											
1446	Birdwood Road	98 Birdwood Road and 39-59 Bradnor Meadows Drive, Ranui	West	Road widening																											
1450	Lincoln Road	6-8, 14, 122-134, 211-221 Lincoln Road and 1-3 Swanson Road, Henderson	West	Road widening																											
1800	Ormiston Road	542 and 568 Ormiston Road, Flat Bush	East / South	Road widening																											
1801	Kerr Road	1 Kerr Road, Manukau City Centre	East / South	Road widening																											
<p>Changes required to be made (maps)</p>	<p>Amend Designations in the Unitary Plan Management Layers in the GIS Viewer by removing the below lapsed designations.</p> <table border="1" data-bbox="416 1525 1404 1951"> <thead> <tr> <th>Designation number</th> <th>Scheme name</th> <th>Address</th> <th>Area</th> <th>Purpose</th> </tr> </thead> <tbody> <tr> <td>1403</td> <td>Red Beach Road</td> <td>55-67 and 76-90 Red Beach Road, Whangaparaoa</td> <td>North</td> <td>Road widening</td> </tr> <tr> <td>1446</td> <td>Birdwood Road</td> <td>98 Birdwood Road and 39-59 Bradnor Meadows Drive, Ranui</td> <td>West</td> <td>Road widening</td> </tr> <tr> <td>1450</td> <td>Lincoln Road</td> <td>6-8, 14, 122-134, 211-221 Lincoln Road and 1-3 Swanson Road, Henderson</td> <td>West</td> <td>Road widening</td> </tr> <tr> <td>1800</td> <td>Ormiston Road</td> <td>542 and 568 Ormiston Road, Flat Bush</td> <td>East / South</td> <td>Road widening</td> </tr> <tr> <td>1801</td> <td>Kerr Road</td> <td>1 Kerr Road, Manukau City Centre</td> <td>East / South</td> <td>Road widening</td> </tr> </tbody> </table>	Designation number	Scheme name	Address	Area	Purpose	1403	Red Beach Road	55-67 and 76-90 Red Beach Road, Whangaparaoa	North	Road widening	1446	Birdwood Road	98 Birdwood Road and 39-59 Bradnor Meadows Drive, Ranui	West	Road widening	1450	Lincoln Road	6-8, 14, 122-134, 211-221 Lincoln Road and 1-3 Swanson Road, Henderson	West	Road widening	1800	Ormiston Road	542 and 568 Ormiston Road, Flat Bush	East / South	Road widening	1801	Kerr Road	1 Kerr Road, Manukau City Centre	East / South	Road widening
Designation number	Scheme name	Address	Area	Purpose																											
1403	Red Beach Road	55-67 and 76-90 Red Beach Road, Whangaparaoa	North	Road widening																											
1446	Birdwood Road	98 Birdwood Road and 39-59 Bradnor Meadows Drive, Ranui	West	Road widening																											
1450	Lincoln Road	6-8, 14, 122-134, 211-221 Lincoln Road and 1-3 Swanson Road, Henderson	West	Road widening																											
1800	Ormiston Road	542 and 568 Ormiston Road, Flat Bush	East / South	Road widening																											
1801	Kerr Road	1 Kerr Road, Manukau City Centre	East / South	Road widening																											
<p>Attachments</p>	<p>Attachment 1: Auckland Transport letter dated 18 November 2021 Attachment 2 : Corrections to text (strikethrough)</p>																														

	Attachment 3: Corrected Auckland Transport designation schedule Attachment 4: GIS Viewer
--	---

Prepared by: Bronnie Styles Planning Technician	Text Entered by: Bronnie Styles Planning Technician
Signature: 	Signature: 
Maps prepared by: Aching Konyak Geospatial Analyst	Reviewed by: Vanessa Leddra Policy Planner
Signature: 	Signature: 
Decision: I agree/disagree to authorise the Clause 20A modification using my delegated authority Celia Davison Manager Planning – Central South Date:	
Signature: 	

**Attachment 1: Auckland Transport letter
dated 18 November 2021**

Attachment 1
Auckland Transport Letter

18 November 2021

Plans and Places
Auckland Council
Private Bag 92300
Auckland 1142

Attn: Jo Hart – Senior Policy Planner; Kasey Zhai – Policy Planner

Via email: unitaryplan@aucklandcouncil.govt.nz

Dear Jo and Kasey,

Auckland Transport designations which will be allowed to lapse in 2021

Auckland Transport is the requiring authority for multiple designations under the Auckland Unitary Plan (the Unitary Plan) which would lapse in November or December 2021, unless given effect to. We have already applied separately to extend the lapse dates for several of these designations, pursuant to section 184(1)(b) of the Resource Management Act 1991.

As part of our application for those extensions, we have demonstrated that we have given “substantial progress or effort...towards giving effect to the designation[s]”, as per section 184(1)(b).

There are other designations expiring imminently where we are unable to demonstrate the required progress or effort. By default, these designations will lapse on the date specified in the Unitary Plan.

The purpose of this letter is to specify, for record-keeping purposes, the five designations that Auckland Transport will implicitly allow to lapse in November or December 2021, by not applying for extensions to their lapse dates. These designations are listed in Table 1 below.

Table 1 – Designations to lapse in 2021

Source: AUP, Chapter K

Designation number	Scheme name	Address	Area	Purpose
1403	Red Beach Road	55-67 and 76-90 Red Beach Road, Whangaparaoa	North	Road widening
1446	Birdwood Road	98 Birdwood Road and 39-59 Bradnor Meadows Drive, Ranui	West	Road widening
1450	Lincoln Road	6-8, 14, 122-134, 211-221 Lincoln Road and 1-3 Swanson Road, Henderson	West	Road widening
1800	Ormiston Road	542 and 568 Ormiston Road, Flat Bush	East / South	Road widening
1801	Kerr Road	1 Kerr Road, Manukau City Centre	East / South	Road widening

We will write to you separately to confirm those designations that we consider to have been given effect to.

Yours faithfully,



Lloyd Johnson
Principal Planner – Consent Planning

Attachment 2

Corrections to text (strikethrough)

Designation Schedule - Auckland Transport (1/3)

North and West

Number	Purpose	Location
1400	Service lane and car park	Leal Place, Manly
1401	Road	Hauti Drive to Blue Gum Drive, Warkworth
1402	Weiti Crossing	East Coast Road, Redvale (crossing Weiti River) to corner Whangaparaoa Road and Cedar Road, Whangaparaoa Transferred to New Zealand Transport Agency (NZTA) on 30 October 2020
1403	Lapsed Road widening	55-67 and 76-90 Red Beach Road, Whangaparaoa
1404	Road widening	470, 473-475, 504-522A, 529-549, 540, 585-587, 593-597, 601, 609-611, 618, 637, 640-644A, 663, 720-728, 736-752, 756-760 and 770A-776 Whangaparaoa Road, 2 Cedar Terrace, 1 Brightside Road, 1 Penton Road, 1 Tower Hill, 2 Homestead Road and 2 Ladies Mile, Whangaparaoa
1406	Car park	Wharf Street, Warkworth
1407	Road widening	Corner of Hudson Road and State Highway 1, Warkworth
1408	Public car park	7A Rawene Road and 204 Hinemoa Street, Birkenhead
1409	Public car park	21 Sunnyhaven Avenue, Beach Haven
1410	Public car park	29 Anzac Road, Browns Bays
1411	Public car park	5 Bute Road, Browns Bay
1412	Public car park	472 Beach Road, Murrays Bay
1413	Public car park	3 Montrose Terrace, Mairangi Bay
1414	Public car park	115 Lake Road and 49-51 Pearn Terrace, Northcote Commercial Centre
1415	Public car park	1A Jutland Road, Hauraki
1416	Public car park	14 Huron Street and 15 Northcroft Street, Takapuna
1417	Public car park	40 Anzac Street, Takapuna
1418	Public car park	139 Kitchener Street, Milford
1419	Public car park	3-5 Fleet Street, Devonport
1420	Constellation Bus Station	62 Parkway Drive, Albany
1421	Albany Bus Station	A250 Oteha Valley Road and 125 McClymonts Road, Albany
1422	Intersection upgrade to provide priority access to the North Shore Busway for buses/high occupancy vehicles	Onewa Road and Sylvan Avenue, Northcote
1423	Akoranga Station	20 Takapuna Landing, Takapuna
1424	Akoranga Station link road	Takapuna Landing, Takapuna
1425	Akoranga Pedestrian Overbridge	20 Takapuna Landing (Akoranga Station), Takapuna (over State Highway 1) to 72 Akoranga Drive (Akoranga Campus), Northcote
1426	Westlake Station	Shakespeare Road (adjoins No. 78 Taharoto Road), Takapuna
1427	Sunnynook Station	168Z Sunnynook Road, Sunnynook
1428	Constellation Drive Station	62 Parkway Drive, Rosedale

1429	Wairau Road / Taharoto Road transport corridor widening and associated works	7-15 Wairau Road and 78Z Taharoto Road, Milford
1430	Public off-street parking ...	23-27 Sir Peter Blake Parade, Bayswater
1431	Road widening	107 Chivalry Road, Glenfield
1432	Road widening	43, 47-51, 55, 59, 65, 69 and 106 Anzac Street, Takapuna
1433	Transport corridor	Fred Taylor Drive, Massey/Whenuapai
1434	Road widening purposes	125A Metcalfe Road to 46 Ranui Station Road, Ranui
1435	Road widening purposes	Waitemata Drive (over Birdwood Park) to Waitemata Drive West, Ranui
1436	Public car parking purposes	331 Great North Road, and 4-6 and 14-20 Edmonton Road, Henderson
1437	Transport corridor	Hobsonville Road, Hobsonville
1438	Public car parking purposes	16 Delta Avenue, New Lynn
1439	Road widening access purposes	7 Fairbanks Place, Glendene
1441	Road widening access purposes	35 Ranui Station Road, Ranui
1442	Service lane	342-344 Great North Road (Henderson Square A), Henderson
1443	Service lane	2 Railside Avenue (Henderson Square B), Henderson
1444	Service lane	McNaughton Way to 11 High Brown Drive, New Lynn
1445	Service lane	60 James Laurie Street to 240C-D Great North Road, Henderson
1446	Lapsed Road widening purposes	98 Birdwood Road and 39-59 Bradnor Meadows Drive, Ranui
1447	Road widening purposes	2-16, 24-26, 28-30 Clark Street, New Lynn
1448	Road widening purposes	1-3 Edmonton Road, Henderson
1449	Road widening purposes	267-287, 290-300, 295-297A, 301-309, 304-318A, 311-325, 429-447, 450, 4004-4012, 4007-4035, 4018, 4022-4024, 4040-4048, 4052-4054, 4070, 4087-4131, 4092-4094, 4098 and 4104-4118A Great North Road, 1-3 West Coast Road, 1 and 2 Montel Avenue, 2 Blacklock Avenue and 1 Buscomb Avenue, Henderson to Te Atatu
1450	Lapsed Road widening purposes	6-8, 14, 122-134, 211-221 Lincoln Road and 1-3 Swanson Road, Henderson
1452	Road widening purposes	241-275, 272-294, 281-314, 300-326, 330-332, 338-342 and 354-358 Te Atatu Road South, 93 Royal View Road, 1, 82 and 85 Jaemont Avenue, 1A and 2A Covil Avenue and 2A Bridge Avenue, Te Atatu
1453	Road widening purposes	2-14, 9-11, 17-35, 30, 40, 44-54, 45-49, 53, 58, 58-64, 65-171A, 68-68A, 74-114 and 118-160 Titirangi Road, 2 Margan Avenue and 1 and 2 Northall Road, Titirangi
1454	Road widening purposes	1-23, 2, 24-34, 25-33, 37-47, 53-59, 63A-141, 64-186, 198-274, 273-347, 282-312, 318-320, 326-360, 351A-409, 370-386 and 390-400 West Coast Road, 69-71 Clayburn Road and 1 Pleasant Road, Glen Eden
1455	Road widening purposes	1-25, 12-40, 37, 47-55A, 52-54, 58, 78, 80A-82, 86-88, 92-94 Swanson Road, Henderson
1456	Pedestrian mall	Pearn Crescent, Northcote
1457	Public off-street parking ...	32 College Road, Northcote

1458	Public off-street parking ...	76 Swanson Road, Henderson
1459	Public off-street parking ...	2 Fenwick Avenue, Milford
1461	Public off-street parking ...	12 Channel View Road, Takapuna
1462	Public off-street parking ...	R78 Hurstmere Road, Takapuna
1463	Public off-street parking ...	20 Clarence Street, Devonport
1464	Public off-street parking ...	5 Trading Place, Henderson
1465	Public off-street parking ...	85 Hurstmere Road, Takapuna
1466	Public off-street parking ...	41 Glenmall Road, Glen Eden
1467	Road widening	Hobsonville Road, Hobsonville
1468	Road widening	State Highway 16 (Westgate to Whenuapai)
1469	Road widening and improvement works.	Albany Highway, Albany
1470	The construction, operation and maintenance of a new road and improvements to the existing Gills Road.	Between Gills Road, Albany (south of Living Stream Road) to Oteha Valley Road (opposite Appian Way), from south of Living Stream Road along Gills Road to east of Lucas Creek bridge.
1471	Roading purposes	Between Mansel Drive and Falls Road, Warkworth.
1472	Withdrawn	
1473	Roading purposes	Land between Northside Drive West, Massey North and Trig Road, Whenuapai
1474	Construction, operation and maintenance of a new road link and associated wetland and improvements to the existing Glenvar Road.	Glenvar Ridge Road, Long Bay
1476	Road – Medallion Drive Link	56 Fairview Avenue, Albany
1477	Road widening and improvement works.	Lincoln Road, Henderson
1478	Road – Matakana Road Link	State Highway 1 to Matakana Road, Warkworth
1479	Construction, operation and maintenance of a road, cycleways, pedestrian paths and associated infrastructure.	<p>Land from Argent Lane roundabout at the intersection with Old Pine Valley Road south through the properties of 10 and 36 Old Pine Valley Road, tying into the existing Pine Valley Road to the north of the property boundary with 1731 Dairy Flat Highway:</p> <ul style="list-style-type: none"> • 10 Old Pine Valley Road (Sec 7 SO 315843, Sec 8 SO 315843, Pt Lot 5 DP 136559) • 36 Old Pine Valley Road (Lot 6 DP 136559) • The public road reserve between the parcels of land that form 10 Old Pine Valley Road.

1480	Construction, operation and maintenance of a partially realigned and upgraded arterial road between Old Pine Valley Road and the Silverdale Motorway Interchange.	<p>Dairy Flat Highway from the edge of the Northern Motorway northbound Silverdale off-ramp to the intersection of Dairy Flat Highway and Pine Valley Road, continuing up Pine Valley Road to the northern property boundary of 1731 Dairy Flat Highway:</p> <ul style="list-style-type: none"> • 1687 Dairy Flat Highway (Lot 1 DP 131154) • 1700 Dairy Flat Highway (Pt Lot 1 DP 68886) • 1731 Dairy Flat Highway (Sec 5 SO 315843, Sec 6 SO 315843, Pt Lot 1 DP 101886) • 1732 Dairy Flat Highway (Pt Lot 2 DP 68886) • Sec 6 SO 308591, Dairy Flat Highway • 36 Old Pine Valley Road (Lot 6 DP 136559)
------	---	--

Designation Schedule - Auckland Transport (3/3)

South

Number	Description	Location
1800	Lapsed Road widening	542 and 568 Ormiston Road, Flat Bush
1801	Lapsed Road widening	1 Kerr Road, Manukau Central
1802	Road widening	128 Ormiston Road, Flat Bush
1804	Public off-street parking ...	143 Pakuranga Road, Pakuranga
1805	Car park and service lane	20 and 24 Uxbridge Road, Howick
1806	Road widening	109 and 129 Beachlands Road, 373, 460, 465, 469, 482, 492, 509, 529, 533, 600, 601-605, 639, 645-651, 650, 691, 702, 712, 722, 732, 746, 751, 758, 770, 781, 824, 830, 855, 865-867 and 897 Whitford-Maraetai Road and 49 and 110A Jack Lachlan Drive, Whitford (Stages 5, 6 and 7)
1807	New road (Whitford Bypass)	40, 51, 54, 58, 83, 133, 172, 173, 201, 227, 231, 230, 232, 238, 250, 257, 284, 330, 371, 374, 376 and 385 Whitford Park Road, 2, 21, 35, 91, 97, 101 and 401 Trig Road, 18, 24 and 30 Saleyard Road, 500 Brookby Road, 53 Polo Lane, 1 and 2 Turanga Road, 49 Clifton Road and 46, 53R, 104R, 109, 130, 150, 186, 299, 373 and 404 Whitford-Maraetai Road (Stages 1, 2, 3 and 4)
1808	Road widening	Ormiston Road and Chapel Road, Flat Bush
1809	Road widening	2, 5, 17, 22-38, 47-59, 56-60 and 67 Allens Road, 3-9 Smales Road, 1 and 2 Harris Road, 2 Ross Reid Place and 61 Sir William Avenue, East Tamaki
1810	Car parking asset	24 Hall St, Pukekohe
1811	Public off-street parking ...	27 Moore Street, Howick
1812	Public off-street parking ...	4 Tobin Street, Pukekohe
1813	Public off-street parking ...	21 Wallace Road, Papatoetoe
1814	Withdrawn	
1815	Withdrawn	
1816	Public off-street parking ...	27 Charles Street, Papatotetoe
1817	Public off-street parking ...	2 Davies Avenue, Manukau
1818	Withdrawn	
1819	Public off-street parking ...	41 Moore Street (Fencible Drive), Howick
1820	Public off-street parking ...	1-13 Maich Road, Papakura
1821	Public off-street parking ...	26-32 O'Shannessy Street, Papakura
1822	Public off-street parking ...	8 Davies Avenue, Manukau
1823	Public off-street parking ...	37 Coles Crescent, Papakura
1824	Public off-street parking ...	15 Eric Baker Place, Papatotetoe

1825	Withdrawn	
1826	Public off-street parking ...	1R Newbury Street, Otara
1827	Public off-street parking ...	21 Shirley Road, Papatoetoe
1828	Public off-street parking ...	9 Wellington Street (Picton Street), Howick
1829	Public off-street parking ...	7 Massey Avenue, Pukekohe
1830	Public off-street parking ...	4 Wellington Street, Howick
1831	Public off-street parking ...	1-49 Waddon Place and 121 Bader Drive, Mangere
1832	Public off-street parking ...	Constable Road (corner King Street), Waiuku
1833	Road widening	Flat Bush School Road and Murphys Road, Flat Bush
1834	Road widening	21 and 39 Flat Bush School Road and 66 Thomas Road, Flat Bush
1835	Upgrade intersection at East Tamaki, Ormiston and Preston Roads in Otara	267Z, 279, 279A, 279B, 279C, 279D, 279E, 279F, 279G, 279H, 279I, 283, 285 and 287 East Tamaki Road, 2, 4, 6, 1/6, 2/6, 3/6, 4/6, 5/6, 6/6, 7/6, 8/6 and 8 Ormiston Road and 208, 208A and 243 Preston Road
1836	The purpose of the designation is to enable the Requiring Authority to widen and upgrade the Redoubt Road-Mill Road Corridor. The public works are required in order to provide future corridor capacity to support growth identified within the Takanini and wider southern area and provide an alternate north/south corridor to State Highway 1.	Parts of Redoubt Road, Mill

1403 Road Widening – Red Beach Road

Designation Number	1403
Requiring Authority	Auckland Transport
Location	55-67 and 76-90 Red Beach Road, Whangaparoa
Rollover Designation	Yes
Legacy Reference	Sheet 4 (First Drawing), Roads to be Widened and Stopped Section of the Planning Maps, Auckland Council District Plan (Rodney Section) 2011
Lapse Date	Five years from being operative in the Unitary Plan unless given effect to prior

Purpose

Road widening.

Conditions

1. In accordance with section 184 of the Resource Management Act 1991, this designation will lapse on the expiry of 5 (five) years after the date on which it is included in the Unitary Plan unless:
 - a. It is given effect to before the end of that period; or
 - b. The territorial authority resolves that it has made, and is continuing to make, substantial progress or effort towards giving effect to the designation and fixes a longer period to give effect to the designation; or
 - c. The designation lapses earlier by virtue of the Unitary Plan ceasing to be operative.

Attachments

No attachments.

1446 Road Widening – Birdwood Road

Designation Number	1446
Requiring Authority	Auckland Transport
Location	8 Birdwood Road and 39-59 Bradner Meadows Drive, Ranui
Rollover Designation	Yes
Legacy Reference	Designation RW1, Auckland Council District Plan (Waitakere Section) 2003
Lapse Date	Five years from being operative in the Unitary Plan unless given effect to prior

Description

Road widening purposes.

Conditions

1. In accordance with section 184 of the Resource Management Act 1991, this designation will lapse on the expiry of 5 (five) years after the date on which it is included in the Unitary Plan unless:
 - a. It is given effect to before the end of that period; or
 - b. The territorial authority resolves that it has made, and is continuing to make, substantial progress or effort towards giving effect to the designation and fixes a longer period to give effect to the designation; or
 - c. The designation lapses earlier by virtue of the Unitary Plan ceasing to be operative.

Attachments

No attachments.

1450 Road Widening – Lincoln Road

Designation Number	1450
Requiring Authority	Auckland Transport
Location	6-8, 14, 122-134, 211-221 Lincoln Road and 1-3 Swanson Road, Henderson
Rollover Designation	Yes
Legacy Reference	Designation RW5, Auckland Council District Plan (Waitakere Section) 2003
Lapse Date	Five years from being operative in the Unitary Plan unless given effect to prior

Purpose

Road widening purposes.

Conditions

1. In accordance with section 184 of the Resource Management Act 1991, this designation will lapse on the expiry of 5 (five) years after the date on which it is included in the Unitary Plan unless:
 - a. It is given effect to before the end of that period; or
 - b. The territorial authority resolves that it has made, and is continuing to make, substantial progress or effort towards giving effect to the designation and fixes a longer period to give effect to the designation; or
 - c. The designation lapses earlier by virtue of the Unitary Plan ceasing to be operative.

Attachments

No attachments.

1800 Road Widening – Ormiston Road

Designation Number	1800
Requiring Authority	Auckland Transport
Location	542 and 568 Ormiston Road, Flat Bush
Rollover Designation	Yes
Legacy Reference	Designation 238, Auckland Council District Plan (Manukau Section) 2002
Lapse Date	5 years from being operative in the Unitary Plan unless given effect to prior

Purpose

Road widening.

Conditions

1. In accordance with section 184 of the Resource Management Act 1991, this designation will lapse on the expiry of 5 (five) years after the date on which it is included in the Unitary Plan unless:
 - a. It is given effect to before the end of that period; or
 - b. The territorial authority resolves that it has made, and is continuing to make, substantial progress or effort towards giving effect to the designation and fixes a longer period to give effect to the designation; or
 - c. The designation lapses earlier by virtue of the Unitary Plan ceasing to be operative.

Attachments

No attachments.

1801 Road Widening – Kerr Road

Designation Number	1801
Requiring Authority	Auckland Transport
Location	1 Kerr Road, Manukau City Centre
Rollover Designation	Yes
Legacy Reference	Designation 239, Auckland Council District Plan (Manukau Section) 2002
Lapse Date	5 years from being operative in the Unitary Plan unless given effect to prior

Purpose

Road widening.

Conditions

1. In accordance with section 184 of the Resource Management Act 1991, this designation will lapse on the expiry of 5 (five) years after the date on which it is included in the Unitary Plan unless:
 - a. It is given effect to before the end of that period; or
 - b. The territorial authority resolves that it has made, and is continuing to make, substantial progress or effort towards giving effect to the designation and fixes a longer period to give effect to the designation; or
 - c. The designation lapses earlier by virtue of the Unitary Plan ceasing to be operative.

Attachments

No attachments.

Attachment 3

Updated Auckland Transport Designation Schedule

Designation Schedule - Auckland Transport (1/3)

North and West

Number	Purpose	Location
1400	Service lane and car park	Leal Place, Manly
1401	Road	Hauti Drive to Blue Gum Drive, Warkworth
1402	Weiti Crossing	East Coast Road, Redvale (crossing Weiti River) to corner Whangaparaoa Road and Cedar Road, Whangaparaoa Transferred to New Zealand Transport Agency (NZTA) on 30 October 2020
1403	Lapsed	
1404	Road widening	470, 473-475, 504-522A, 529-549, 540, 585-587, 593-597, 601, 609-611, 618, 637, 640-644A, 663, 720-728, 736-752, 756-760 and 770A-776 Whangaparaoa Road, 2 Cedar Terrace, 1 Brightside Road, 1 Penton Road, 1 Tower Hill, 2 Homestead Road and 2 Ladies Mile, Whangaparaoa
1406	Car park	Wharf Street, Warkworth
1407	Road widening	Corner of Hudson Road and State Highway 1, Warkworth
1408	Public car park	7A Rawene Road and 204 Hinemoa Street, Birkenhead
1409	Public car park	21 Sunnyhaven Avenue, Beach Haven
1410	Public car park	29 Anzac Road, Browns Bays
1411	Public car park	5 Bute Road, Browns Bay
1412	Public car park	472 Beach Road, Murrays Bay
1413	Public car park	3 Montrose Terrace, Mairangi Bay
1414	Public car park	115 Lake Road and 49-51 Pearn Terrace, Northcote Commercial Centre
1415	Public car park	1A Jutland Road, Hauraki
1416	Public car park	14 Huron Street and 15 Northcroft Street, Takapuna
1417	Public car park	40 Anzac Street, Takapuna
1418	Public car park	139 Kitchener Street, Milford
1419	Public car park	3-5 Fleet Street, Devonport
1420	Constellation Bus Station	62 Parkway Drive, Albany
1421	Albany Bus Station	A250 Oteha Valley Road and 125 McClymonts Road, Albany
1422	Intersection upgrade to provide priority access to the North Shore Busway for buses/high occupancy vehicles	Onewa Road and Sylvan Avenue, Northcote
1423	Akoranga Station	20 Takapuna Landing, Takapuna
1424	Akoranga Station link road	Takapuna Landing, Takapuna
1425	Akoranga Pedestrian Overbridge	20 Takapuna Landing (Akoranga Station), Takapuna (over State Highway 1) to 72 Akoranga Drive (Akoranga Campus), Northcote
1426	Westlake Station	Shakespeare Road (adjoins No. 78 Taharoto Road), Takapuna
1427	Sunnynook Station	168Z Sunnynook Road, Sunnynook
1428	Constellation Drive Station	62 Parkway Drive, Rosedale
1429	Wairau Road / Taharoto Road	7-15 Wairau Road and 78Z Taharoto Road, Milford

	transport corridor widening and associated works	
1430	Public off-street parking ...	23-27 Sir Peter Blake Parade, Bayswater
1431	Road widening	107 Chivalry Road, Glenfield
1432	Road widening	43, 47-51, 55, 59, 65, 69 and 106 Anzac Street, Takapuna
1433	Transport corridor	Fred Taylor Drive, Massey/Whenuapai
1434	Road widening purposes	125A Metcalfe Road to 46 Ranui Station Road, Ranui
1435	Road widening purposes	Waitemata Drive (over Birdwood Park) to Waitemata Drive West, Ranui
1436	Public car parking purposes	331 Great North Road, and 4-6 and 14-20 Edmonton Road, Henderson
1437	Transport corridor	Hobsonville Road, Hobsonville
1438	Public car parking purposes	16 Delta Avenue, New Lynn
1439	Road widening access purposes	7 Fairbanks Place, Glendene
1441	Road widening access purposes	35 Ranui Station Road, Ranui
1442	Service lane	342-344 Great North Road (Henderson Square A), Henderson
1443	Service lane	2 Railside Avenue (Henderson Square B), Henderson
1444	Service lane	McNaughton Way to 11 High Brown Drive, New Lynn
1445	Service lane	60 James Laurie Street to 240C-D Great North Road, Henderson
1446	Lapsed	
1447	Road widening purposes	2-16, 24-26, 28-30 Clark Street, New Lynn
1448	Road widening purposes	1-3 Edmonton Road, Henderson
1449	Road widening purposes	267-287, 290-300, 295-297A, 301-309, 304-318A, 311-325, 429-447, 450, 4004-4012, 4007-4035, 4018, 4022-4024, 4040-4048, 4052-4054, 4070, 4087-4131, 4092-4094, 4098 and 4104-4118A Great North Road, 1-3 West Coast Road, 1 and 2 Montel Avenue, 2 Blacklock Avenue and 1 Buscomb Avenue, Henderson to Te Atatu
1450	Lapsed	
1452	Road widening purposes	241-275, 272-294, 281-314, 300-326, 330-332, 338-342 and 354-358 Te Atatu Road South, 93 Royal View Road, 1, 82 and 85 Jaemont Avenue, 1A and 2A Covil Avenue and 2A Bridge Avenue, Te Atatu
1453	Road widening purposes	2-14, 9-11, 17-35, 30, 40, 44-54, 45-49, 53, 58, 58-64, 65-171A, 68-68A, 74-114 and 118-160 Titirangi Road, 2 Margan Avenue and 1 and 2 Northhall Road, Titirangi
1454	Road widening purposes	1-23, 2, 24-34, 25-33, 37-47, 53-59, 63A-141, 64-186, 198-274, 273-347, 282-312, 318-320, 326-360, 351A-409, 370-386 and 390-400 West Coast Road, 69-71 Clayburn Road and 1 Pleasant Road, Glen Eden
1455	Road widening purposes	1-25, 12-40, 37,47-55A, 52-54, 58, 78, 80A-82, 86-88, 92-94 Swanson Road, Henderson
1456	Pedestrian mall	Pearn Crescent, Northcote
1457	Public off-street parking ...	32 College Road, Northcote
1458	Public off-street parking ...	76 Swanson Road, Henderson
1459	Public off-street parking ...	2 Fenwick Avenue, Milford

1461	Public off-street parking ...	12 Channel View Road, Takapuna
1462	Public off-street parking ...	R78 Hurstmere Road, Takapuna
1463	Public off-street parking ...	20 Clarence Street, Devonport
1464	Public off-street parking ...	5 Trading Place, Henderson
1465	Public off-street parking ...	85 Hurstmere Road, Takapuna
1466	Public off-street parking ...	41 Glenmall Road, Glen Eden
1467	Road widening	Hobsonville Road, Hobsonville
1468	Road widening	State Highway 16 (Westgate to Whenuapai)
1469	Road widening and improvement works.	Albany Highway, Albany
1470	The construction, operation and maintenance of a new road and improvements to the existing Gills Road.	Between Gills Road, Albany (south of Living Stream Road) to Oteha Valley Road (opposite Appian Way), from south of Living Stream Road along Gills Road to east of Lucas Creek bridge.
1471	Roading purposes	Between Mansel Drive and Falls Road, Warkworth.
1472	Withdrawn	
1473	Roading purposes	Land between Northside Drive West, Massey North and Trig Road, Whenuapai
1474	Construction, operation and maintenance of a new road link and associated wetland and improvements to the existing Glenvar Road.	Glenvar Ridge Road, Long Bay
1476	Road – Medallion Drive Link	56 Fairview Avenue, Albany
1477	Road widening and improvement works.	Lincoln Road, Henderson
1478	Road – Matakana Road Link	State Highway 1 to Matakana Road, Warkworth
1479	Construction, operation and maintenance of a road, cycleways, pedestrian paths and associated infrastructure.	<p>Land from Argent Lane roundabout at the intersection with Old Pine Valley Road south through the properties of 10 and 36 Old Pine Valley Road, tying into the existing Pine Valley Road to the north of the property boundary with 1731 Dairy Flat Highway:</p> <ul style="list-style-type: none"> • 10 Old Pine Valley Road (Sec 7 SO 315843, Sec 8 SO 315843, Pt Lot 5 DP 136559) • 36 Old Pine Valley Road (Lot 6 DP 136559) • The public road reserve between the parcels of land that form 10 Old Pine Valley Road.

1480	Construction, operation and maintenance of a partially realigned and upgraded arterial road between Old Pine Valley Road and the Silverdale Motorway Interchange.	<p>Dairy Flat Highway from the edge of the Northern Motorway northbound Silverdale off-ramp to the intersection of Dairy Flat Highway and Pine Valley Road, continuing up Pine Valley Road to the northern property boundary of 1731 Dairy Flat Highway:</p> <ul style="list-style-type: none"> • 1687 Dairy Flat Highway (Lot 1 DP 131154) • 1700 Dairy Flat Highway (Pt Lot 1 DP 68886) • 1731 Dairy Flat Highway (Sec 5 SO 315843, Sec 6 SO 315843, Pt Lot 1 DP 101886) • 1732 Dairy Flat Highway (Pt Lot 2 DP 68886) • Sec 6 SO 308591, Dairy Flat Highway • 36 Old Pine Valley Road (Lot 6 DP 136559)
------	---	--

Designation Schedule - Auckland Transport (3/3)

South

Number	Description	Location
1800	Lapsed	
1801	Lapsed	
1802	Road widening	128 Ormiston Road, Flat Bush
1804	Public off-street parking ...	143 Pakuranga Road, Pakuranga
1805	Car park and service lane	20 and 24 Uxbridge Road, Howick
1806	Road widening	109 and 129 Beachlands Road, 373, 460, 465, 469, 482, 492, 509, 529, 533, 600, 601-605, 639, 645-651, 650, 691, 702, 712, 722, 732, 746, 751, 758, 770, 781, 824, 830, 855, 865-867 and 897 Whitford-Maraetai Road and 49 and 110A Jack Lachlan Drive, Whitford (Stages 5, 6 and 7)
1807	New road (Whitford Bypass)	40, 51, 54, 58, 83, 133, 172, 173, 201, 227, 231, 230, 232, 238, 250, 257, 284, 330, 371, 374, 376 and 385 Whitford Park Road, 2, 21, 35, 91, 97, 101 and 401 Trig Road, 18, 24 and 30 Saleyard Road, 500 Brookby Road, 53 Polo Lane, 1 and 2 Turanga Road, 49 Clifton Road and 46, 53R, 104R, 109, 130, 150, 186, 299, 373 and 404 Whitford-Maraetai Road (Stages 1, 2, 3 and 4)
1808	Road widening	Ormiston Road and Chapel Road, Flat Bush
1809	Road widening	2, 5, 17, 22-38, 47-59, 56-60 and 67 Allens Road, 3-9 Smales Road, 1 and 2 Harris Road, 2 Ross Reid Place and 61 Sir William Avenue, East Tamaki
1810	Car parking asset	24 Hall St, Pukekohe
1811	Public off-street parking ...	27 Moore Street, Howick
1812	Public off-street parking ...	4 Tobin Street, Pukekohe
1813	Public off-street parking ...	21 Wallace Road, Papatoetoe
1814	Withdrawn	
1815	Withdrawn	
1816	Public off-street parking ...	27 Charles Street, Papatotetoe
1817	Public off-street parking ...	2 Davies Avenue, Manukau
1818	Withdrawn	
1819	Public off-street parking ...	41 Moore Street (Fencible Drive), Howick
1820	Public off-street parking ...	1-13 Maich Road, Papakura
1821	Public off-street parking ...	26-32 O'Shannessy Street, Papakura
1822	Public off-street parking ...	8 Davies Avenue, Manukau
1823	Public off-street parking ...	37 Coles Crescent, Papakura
1824	Public off-street parking ...	15 Eric Baker Place, Papatotetoe
1825	Withdrawn	

1826	Public off-street parking ...	1R Newbury Street, Otara
1827	Public off-street parking ...	21 Shirley Road, Papatoetoe
1828	Public off-street parking ...	9 Wellington Street (Picton Street), Howick
1829	Public off-street parking ...	7 Massey Avenue, Pukekohe
1830	Public off-street parking ...	4 Wellington Street, Howick
1831	Public off-street parking ...	1-49 Waddon Place and 121 Bader Drive, Mangere
1832	Public off-street parking ...	Constable Road (corner King Street), Waiuku
1833	Road widening	Flat Bush School Road and Murphys Road, Flat Bush
1834	Road widening	21 and 39 Flat Bush School Road and 66 Thomas Road, Flat Bush
1835	Upgrade intersection at East Tamaki, Ormiston and Preston Roads in Otara	267Z, 279, 279A, 279B, 279C, 279D, 279E, 279F, 279G, 279H, 279I, 283, 285 and 287 East Tamaki Road, 2, 4, 6, 1/6, 2/6, 3/6, 4/6, 5/6, 6/6, 7/6, 8/6 and 8 Ormiston Road and 208, 208A and 243 Preston Road
1836	The purpose of the designation is to enable the Requiring Authority to widen and upgrade the Redoubt Road-Mill Road Corridor. The public works are required in order to provide future corridor capacity to support growth identified within the Takanini and wider southern area and provide an alternate north/south corridor to State Highway 1.	Parts of Redoubt Road, Mill

Attachment 4
GIS Viewer

Attachment 2 : Corrections to text (strikethrough)

Designation Schedule - Auckland Transport (1/3)

North and West

Number	Purpose	Location
1400	Service lane and car park	Leal Place, Manly
1401	Road	Hauti Drive to Blue Gum Drive, Warkworth
1402	Weiti Crossing	East Coast Road, Redvale (crossing Weiti River) to corner Whangaparaoa Road and Cedar Road, Whangaparaoa Transferred to New Zealand Transport Agency (NZTA) on 30 October 2020
1403	Lapsed Road widening	55-67 and 76-90 Red Beach Road, Whangaparaoa
1404	Road widening	470, 473-475, 504-522A, 529-549, 540, 585-587, 593-597, 601, 609-611, 618, 637, 640-644A, 663, 720-728, 736-752, 756-760 and 770A-776 Whangaparaoa Road, 2 Cedar Terrace, 1 Brightside Road, 1 Penton Road, 1 Tower Hill, 2 Homestead Road and 2 Ladies Mile, Whangaparaoa
1406	Car park	Wharf Street, Warkworth
1407	Road widening	Corner of Hudson Road and State Highway 1, Warkworth
1408	Public car park	7A Rawene Road and 204 Hinemoa Street, Birkenhead
1409	Public car park	21 Sunnyhaven Avenue, Beach Haven
1410	Public car park	29 Anzac Road, Browns Bays
1411	Public car park	5 Bute Road, Browns Bay
1412	Public car park	472 Beach Road, Murrays Bay
1413	Public car park	3 Montrose Terrace, Mairangi Bay
1414	Public car park	115 Lake Road and 49-51 Pearn Terrace, Northcote Commercial Centre
1415	Public car park	1A Jutland Road, Hauraki
1416	Public car park	14 Huron Street and 15 Northcroft Street, Takapuna
1417	Public car park	40 Anzac Street, Takapuna
1418	Public car park	139 Kitchener Street, Milford
1419	Public car park	3-5 Fleet Street, Devonport
1420	Constellation Bus Station	62 Parkway Drive, Albany
1421	Albany Bus Station	A250 Oteha Valley Road and 125 McClymonts Road, Albany
1422	Intersection upgrade to provide priority access to the North Shore Busway for buses/high occupancy vehicles	Onewa Road and Sylvan Avenue, Northcote
1423	Akoranga Station	20 Takapuna Landing, Takapuna
1424	Akoranga Station link road	Takapuna Landing, Takapuna
1425	Akoranga Pedestrian Overbridge	20 Takapuna Landing (Akoranga Station), Takapuna (over State Highway 1) to 72 Akoranga Drive (Akoranga Campus), Northcote
1426	Westlake Station	Shakespeare Road (adjoins No. 78 Taharoto Road), Takapuna
1427	Sunnynook Station	168Z Sunnynook Road, Sunnynook
1428	Constellation Drive Station	62 Parkway Drive, Rosedale

1429	Wairau Road / Taharoto Road transport corridor widening and associated works	7-15 Wairau Road and 78Z Taharoto Road, Milford
1430	Public off-street parking ...	23-27 Sir Peter Blake Parade, Bayswater
1431	Road widening	107 Chivalry Road, Glenfield
1432	Road widening	43, 47-51, 55, 59, 65, 69 and 106 Anzac Street, Takapuna
1433	Transport corridor	Fred Taylor Drive, Massey/Whenuapai
1434	Road widening purposes	125A Metcalfe Road to 46 Ranui Station Road, Ranui
1435	Road widening purposes	Waitemata Drive (over Birdwood Park) to Waitemata Drive West, Ranui
1436	Public car parking purposes	331 Great North Road, and 4-6 and 14-20 Edmonton Road, Henderson
1437	Transport corridor	Hobsonville Road, Hobsonville
1438	Public car parking purposes	16 Delta Avenue, New Lynn
1439	Road widening access purposes	7 Fairbanks Place, Glendene
1441	Road widening access purposes	35 Ranui Station Road, Ranui
1442	Service lane	342-344 Great North Road (Henderson Square A), Henderson
1443	Service lane	2 Railside Avenue (Henderson Square B), Henderson
1444	Service lane	McNaughton Way to 11 High Brown Drive, New Lynn
1445	Service lane	60 James Laurie Street to 240C-D Great North Road, Henderson
1446	Lapsed Road widening purposes	98 Birdwood Road and 39-59 Bradnor Meadows Drive, Ranui
1447	Road widening purposes	2-16, 24-26, 28-30 Clark Street, New Lynn
1448	Road widening purposes	1-3 Edmonton Road, Henderson
1449	Road widening purposes	267-287, 290-300, 295-297A, 301-309, 304-318A, 311-325, 429-447, 450, 4004-4012, 4007-4035, 4018, 4022-4024, 4040-4048, 4052-4054, 4070, 4087-4131, 4092-4094, 4098 and 4104-4118A Great North Road, 1-3 West Coast Road, 1 and 2 Montel Avenue, 2 Blacklock Avenue and 1 Buscomb Avenue, Henderson to Te Atatu
1450	Lapsed Road widening purposes	6-8, 14, 122-134, 211-221 Lincoln Road and 1-3 Swanson Road, Henderson
1452	Road widening purposes	241-275, 272-294, 281-314, 300-326, 330-332, 338-342 and 354-358 Te Atatu Road South, 93 Royal View Road, 1, 82 and 85 Jaemont Avenue, 1A and 2A Covil Avenue and 2A Bridge Avenue, Te Atatu
1453	Road widening purposes	2-14, 9-11, 17-35, 30, 40, 44-54, 45-49, 53, 58, 58-64, 65-171A, 68-68A, 74-114 and 118-160 Titirangi Road, 2 Margan Avenue and 1 and 2 Northall Road, Titirangi
1454	Road widening purposes	1-23, 2, 24-34, 25-33, 37-47, 53-59, 63A-141, 64-186, 198-274, 273-347, 282-312, 318-320, 326-360, 351A-409, 370-386 and 390-400 West Coast Road, 69-71 Clayburn Road and 1 Pleasant Road, Glen Eden
1455	Road widening purposes	1-25, 12-40, 37, 47-55A, 52-54, 58, 78, 80A-82, 86-88, 92-94 Swanson Road, Henderson
1456	Pedestrian mall	Pearn Crescent, Northcote
1457	Public off-street parking ...	32 College Road, Northcote

1458	Public off-street parking ...	76 Swanson Road, Henderson
1459	Public off-street parking ...	2 Fenwick Avenue, Milford
1461	Public off-street parking ...	12 Channel View Road, Takapuna
1462	Public off-street parking ...	R78 Hurstmere Road, Takapuna
1463	Public off-street parking ...	20 Clarence Street, Devonport
1464	Public off-street parking ...	5 Trading Place, Henderson
1465	Public off-street parking ...	85 Hurstmere Road, Takapuna
1466	Public off-street parking ...	41 Glenmall Road, Glen Eden
1467	Road widening	Hobsonville Road, Hobsonville
1468	Road widening	State Highway 16 (Westgate to Whenuapai)
1469	Road widening and improvement works.	Albany Highway, Albany
1470	The construction, operation and maintenance of a new road and improvements to the existing Gills Road.	Between Gills Road, Albany (south of Living Stream Road) to Oteha Valley Road (opposite Appian Way), from south of Living Stream Road along Gills Road to east of Lucas Creek bridge.
1471	Roading purposes	Between Mansel Drive and Falls Road, Warkworth.
1472	Withdrawn	
1473	Roading purposes	Land between Northside Drive West, Massey North and Trig Road, Whenuapai
1474	Construction, operation and maintenance of a new road link and associated wetland and improvements to the existing Glenvar Road.	Glenvar Ridge Road, Long Bay
1476	Road – Medallion Drive Link	56 Fairview Avenue, Albany
1477	Road widening and improvement works.	Lincoln Road, Henderson
1478	Road – Matakana Road Link	State Highway 1 to Matakana Road, Warkworth
1479	Construction, operation and maintenance of a road, cycleways, pedestrian paths and associated infrastructure.	<p>Land from Argent Lane roundabout at the intersection with Old Pine Valley Road south through the properties of 10 and 36 Old Pine Valley Road, tying into the existing Pine Valley Road to the north of the property boundary with 1731 Dairy Flat Highway:</p> <ul style="list-style-type: none"> • 10 Old Pine Valley Road (Sec 7 SO 315843, Sec 8 SO 315843, Pt Lot 5 DP 136559) • 36 Old Pine Valley Road (Lot 6 DP 136559) • The public road reserve between the parcels of land that form 10 Old Pine Valley Road.

1480	Construction, operation and maintenance of a partially realigned and upgraded arterial road between Old Pine Valley Road and the Silverdale Motorway Interchange.	<p>Dairy Flat Highway from the edge of the Northern Motorway northbound Silverdale off-ramp to the intersection of Dairy Flat Highway and Pine Valley Road, continuing up Pine Valley Road to the northern property boundary of 1731 Dairy Flat Highway:</p> <ul style="list-style-type: none"> • 1687 Dairy Flat Highway (Lot 1 DP 131154) • 1700 Dairy Flat Highway (Pt Lot 1 DP 68886) • 1731 Dairy Flat Highway (Sec 5 SO 315843, Sec 6 SO 315843, Pt Lot 1 DP 101886) • 1732 Dairy Flat Highway (Pt Lot 2 DP 68886) • Sec 6 SO 308591, Dairy Flat Highway • 36 Old Pine Valley Road (Lot 6 DP 136559)
------	---	--

Designation Schedule - Auckland Transport (3/3)

South

Number	Description	Location
1800	Lapsed Road widening	542 and 568 Ormiston Road, Flat Bush
1801	Lapsed Road widening	1 Kerr Road, Manukau Central
1802	Road widening	128 Ormiston Road, Flat Bush
1804	Public off-street parking ...	143 Pakuranga Road, Pakuranga
1805	Car park and service lane	20 and 24 Uxbridge Road, Howick
1806	Road widening	109 and 129 Beachlands Road, 373, 460, 465, 469, 482, 492, 509, 529, 533, 600, 601-605, 639, 645-651, 650, 691, 702, 712, 722, 732, 746, 751, 758, 770, 781, 824, 830, 855, 865-867 and 897 Whitford-Maraetai Road and 49 and 110A Jack Lachlan Drive, Whitford (Stages 5, 6 and 7)
1807	New road (Whitford Bypass)	40, 51, 54, 58, 83, 133, 172, 173, 201, 227, 231, 230, 232, 238, 250, 257, 284, 330, 371, 374, 376 and 385 Whitford Park Road, 2, 21, 35, 91, 97, 101 and 401 Trig Road, 18, 24 and 30 Saleyard Road, 500 Brookby Road, 53 Polo Lane, 1 and 2 Turanga Road, 49 Clifton Road and 46, 53R, 104R, 109, 130, 150, 186, 299, 373 and 404 Whitford-Maraetai Road (Stages 1, 2, 3 and 4)
1808	Road widening	Ormiston Road and Chapel Road, Flat Bush
1809	Road widening	2, 5, 17, 22-38, 47-59, 56-60 and 67 Allens Road, 3-9 Smales Road, 1 and 2 Harris Road, 2 Ross Reid Place and 61 Sir William Avenue, East Tamaki
1810	Car parking asset	24 Hall St, Pukekohe
1811	Public off-street parking ...	27 Moore Street, Howick
1812	Public off-street parking ...	4 Tobin Street, Pukekohe
1813	Public off-street parking ...	21 Wallace Road, Papatoetoe
1814	Withdrawn	
1815	Withdrawn	
1816	Public off-street parking ...	27 Charles Street, Papatotetoe
1817	Public off-street parking ...	2 Davies Avenue, Manukau
1818	Withdrawn	
1819	Public off-street parking ...	41 Moore Street (Fencible Drive), Howick
1820	Public off-street parking ...	1-13 Maich Road, Papakura
1821	Public off-street parking ...	26-32 O'Shannessy Street, Papakura
1822	Public off-street parking ...	8 Davies Avenue, Manukau
1823	Public off-street parking ...	37 Coles Crescent, Papakura
1824	Public off-street parking ...	15 Eric Baker Place, Papatotetoe

1825	Withdrawn	
1826	Public off-street parking ...	1R Newbury Street, Otara
1827	Public off-street parking ...	21 Shirley Road, Papatoetoe
1828	Public off-street parking ...	9 Wellington Street (Picton Street), Howick
1829	Public off-street parking ...	7 Massey Avenue, Pukekohe
1830	Public off-street parking ...	4 Wellington Street, Howick
1831	Public off-street parking ...	1-49 Waddon Place and 121 Bader Drive, Mangere
1832	Public off-street parking ...	Constable Road (corner King Street), Waiuku
1833	Road widening	Flat Bush School Road and Murphys Road, Flat Bush
1834	Road widening	21 and 39 Flat Bush School Road and 66 Thomas Road, Flat Bush
1835	Upgrade intersection at East Tamaki, Ormiston and Preston Roads in Otara	267Z, 279, 279A, 279B, 279C, 279D, 279E, 279F, 279G, 279H, 279I, 283, 285 and 287 East Tamaki Road, 2, 4, 6, 1/6, 2/6, 3/6, 4/6, 5/6, 6/6, 7/6, 8/6 and 8 Ormiston Road and 208, 208A and 243 Preston Road
1836	The purpose of the designation is to enable the Requiring Authority to widen and upgrade the Redoubt Road-Mill Road Corridor. The public works are required in order to provide future corridor capacity to support growth identified within the Takanini and wider southern area and provide an alternate north/south corridor to State Highway 1.	Parts of Redoubt Road, Mill

1403 Road Widening – Red Beach Road

Designation Number	1403
Requiring Authority	Auckland Transport
Location	55-67 and 76-90 Red Beach Road, Whangaparoa
Rollover Designation	Yes
Legacy Reference	Sheet 4 (First Drawing), Roads to be Widened and Stopped Section of the Planning Maps, Auckland Council District Plan (Rodney Section) 2011
Lapse Date	Five years from being operative in the Unitary Plan unless given effect to prior

Purpose

Road widening.

Conditions

1. In accordance with section 184 of the Resource Management Act 1991, this designation will lapse on the expiry of 5 (five) years after the date on which it is included in the Unitary Plan unless:
 - a. It is given effect to before the end of that period; or
 - b. The territorial authority resolves that it has made, and is continuing to make, substantial progress or effort towards giving effect to the designation and fixes a longer period to give effect to the designation; or
 - c. The designation lapses earlier by virtue of the Unitary Plan ceasing to be operative.

Attachments

No attachments.

1446 Road Widening – Birdwood Road

Designation Number	1446
Requiring Authority	Auckland Transport
Location	8 Birdwood Road and 39-59 Bradner Meadows Drive, Ranui
Rollover Designation	Yes
Legacy Reference	Designation RW1, Auckland Council District Plan (Waitakere Section) 2003-
Lapse Date	Five years from being operative in the Unitary Plan unless given effect to prior

Description

Road widening purposes.

Conditions

1. In accordance with section 184 of the Resource Management Act 1991, this designation will lapse on the expiry of 5 (five) years after the date on which it is included in the Unitary Plan unless:
 - a. It is given effect to before the end of that period; or
 - b. The territorial authority resolves that it has made, and is continuing to make, substantial progress or effort towards giving effect to the designation and fixes a longer period to give effect to the designation; or
 - c. The designation lapses earlier by virtue of the Unitary Plan ceasing to be operative.

Attachments

No attachments.

1450 Road Widening – Lincoln Road

Designation Number	1450
Requiring Authority	Auckland Transport
Location	6-8, 14, 122-134, 211-221 Lincoln Road and 1-3 Swanson Road, Henderson
Rollover Designation	Yes
Legacy Reference	Designation RW5, Auckland Council District Plan (Waitakere Section) 2003
Lapse Date	Five years from being operative in the Unitary Plan unless given effect to prior

Purpose

Road widening purposes.

Conditions

1. In accordance with section 184 of the Resource Management Act 1991, this designation will lapse on the expiry of 5 (five) years after the date on which it is included in the Unitary Plan unless:
 - a. It is given effect to before the end of that period; or
 - b. The territorial authority resolves that it has made, and is continuing to make, substantial progress or effort towards giving effect to the designation and fixes a longer period to give effect to the designation; or
 - c. The designation lapses earlier by virtue of the Unitary Plan ceasing to be operative.

Attachments

No attachments.

1800 Road Widening – Ormiston Road

Designation Number	1800
Requiring Authority	Auckland Transport
Location	542 and 568 Ormiston Road, Flat Bush
Rollover Designation	Yes
Legacy Reference	Designation 238, Auckland Council District Plan (Manukau Section) 2002
Lapse Date	5 years from being operative in the Unitary Plan unless given effect to prior

Purpose

Road widening.

Conditions

1. In accordance with section 184 of the Resource Management Act 1991, this designation will lapse on the expiry of 5 (five) years after the date on which it is included in the Unitary Plan unless:
 - a. It is given effect to before the end of that period; or
 - b. The territorial authority resolves that it has made, and is continuing to make, substantial progress or effort towards giving effect to the designation and fixes a longer period to give effect to the designation; or
 - c. The designation lapses earlier by virtue of the Unitary Plan ceasing to be operative.

Attachments

No attachments.

1801 Road Widening – Kerr Road

Designation Number	1801
Requiring Authority	Auckland Transport
Location	1 Kerr Road, Manukau City Centre
Rollover Designation	Yes
Legacy Reference	Designation 239, Auckland Council District Plan (Manukau Section) 2002
Lapse Date	5 years from being operative in the Unitary Plan unless given effect to prior

Purpose

Road widening.

Conditions

1. In accordance with section 184 of the Resource Management Act 1991, this designation will lapse on the expiry of 5 (five) years after the date on which it is included in the Unitary Plan unless:
 - a. It is given effect to before the end of that period; or
 - b. The territorial authority resolves that it has made, and is continuing to make, substantial progress or effort towards giving effect to the designation and fixes a longer period to give effect to the designation; or
 - c. The designation lapses earlier by virtue of the Unitary Plan ceasing to be operative.

Attachments

No attachments.

Attachment 3: Corrected Auckland Transport designation schedule

Designation Schedule - Auckland Transport (1/3)

North and West

Number	Purpose	Location
1400	Service lane and car park	Leal Place, Manly
1401	Road	Hauti Drive to Blue Gum Drive, Warkworth
1402-	Weiti Crossing	East Coast Road, Redvale (crossing Weiti River) to corner Whangaparaoa Road and Cedar Road, Whangaparaoa Transferred to New Zealand Transport Agency (NZTA) on 30 October 2020
1403	Lapsed	
1404	Road widening	470, 473-475, 504-522A, 529-549, 540, 585-587, 593-597, 601, 609-611, 618, 637, 640-644A, 663, 720-728, 736-752, 756-760 and 770A-776 Whangaparaoa Road, 2 Cedar Terrace, 1 Brightside Road, 1 Penton Road, 1 Tower Hill, 2 Homestead Road and 2 Ladies Mile, Whangaparaoa
1406	Car park	Wharf Street, Warkworth
1407	Road widening	Corner of Hudson Road and State Highway 1, Warkworth
1408	Public car park	7A Rawene Road and 204 Hinemoa Street, Birkenhead
1409	Public car park	21 Sunnyhaven Avenue, Beach Haven
1410	Public car park	29 Anzac Road, Browns Bays
1411	Public car park	5 Bute Road, Browns Bay
1412	Public car park	472 Beach Road, Murrays Bay
1413	Public car park	3 Montrose Terrace, Mairangi Bay
1414	Public car park	115 Lake Road and 49-51 Pearn Terrace, Northcote Commercial Centre
1415	Public car park	1A Jutland Road, Hauraki
1416	Public car park	14 Huron Street and 15 Northcroft Street, Takapuna
1417	Public car park	40 Anzac Street, Takapuna
1418	Public car park	139 Kitchener Street, Milford
1419	Public car park	3-5 Fleet Street, Devonport
1420	Constellation Bus Station	62 Parkway Drive, Albany
1421	Albany Bus Station	A250 Oteha Valley Road and 125 McClymonts Road, Albany
1422	Intersection upgrade to provide priority access to the North Shore Busway for buses/high occupancy vehicles	Onewa Road and Sylvan Avenue, Northcote
1423	Akoranga Station	20 Takapuna Landing, Takapuna
1424	Akoranga Station link road	Takapuna Landing, Takapuna
1425	Akoranga Pedestrian Overbridge	20 Takapuna Landing (Akoranga Station), Takapuna (over State Highway 1) to 72 Akoranga Drive (Akoranga Campus), Northcote
1426	Westlake Station	Shakespeare Road (adjoins No. 78 Taharoto Road), Takapuna
1427	Sunnynook Station	168Z Sunnynook Road, Sunnynook
1428	Constellation Drive Station	62 Parkway Drive, Rosedale
1429	Wairau Road / Taharoto Road	7-15 Wairau Road and 78Z Taharoto Road, Milford

	transport corridor widening and associated works	
1430	Public off-street parking ...	23-27 Sir Peter Blake Parade, Bayswater
1431	Road widening	107 Chivalry Road, Glenfield
1432	Road widening	43, 47-51, 55, 59, 65, 69 and 106 Anzac Street, Takapuna
1433	Transport corridor	Fred Taylor Drive, Massey/Whenuapai
1434	Road widening purposes	125A Metcalfe Road to 46 Ranui Station Road, Ranui
1435	Road widening purposes	Waitemata Drive (over Birdwood Park) to Waitemata Drive West, Ranui
1436	Public car parking purposes	331 Great North Road, and 4-6 and 14-20 Edmonton Road, Henderson
1437	Transport corridor	Hobsonville Road, Hobsonville
1438	Public car parking purposes	16 Delta Avenue, New Lynn
1439	Road widening access purposes	7 Fairbanks Place, Glendene
1441	Road widening access purposes	35 Ranui Station Road, Ranui
1442	Service lane	342-344 Great North Road (Henderson Square A), Henderson
1443	Service lane	2 Railside Avenue (Henderson Square B), Henderson
1444	Service lane	McNaughton Way to 11 High Brown Drive, New Lynn
1445	Service lane	60 James Laurie Street to 240C-D Great North Road, Henderson
1446	Lapsed	
1447	Road widening purposes	2-16, 24-26, 28-30 Clark Street, New Lynn
1448	Road widening purposes	1-3 Edmonton Road, Henderson
1449	Road widening purposes	267-287, 290-300, 295-297A, 301-309, 304-318A, 311-325, 429-447, 450, 4004-4012, 4007-4035, 4018, 4022-4024, 4040-4048, 4052-4054, 4070, 4087-4131, 4092-4094, 4098 and 4104-4118A Great North Road, 1-3 West Coast Road, 1 and 2 Montel Avenue, 2 Blacklock Avenue and 1 Buscomb Avenue, Henderson to Te Atatu
1450	Lapsed	
1452	Road widening purposes	241-275, 272-294, 281-314, 300-326, 330-332, 338-342 and 354-358 Te Atatu Road South, 93 Royal View Road, 1, 82 and 85 Jaemont Avenue, 1A and 2A Covil Avenue and 2A Bridge Avenue, Te Atatu
1453	Road widening purposes	2-14, 9-11, 17-35, 30, 40, 44-54, 45-49, 53, 58, 58-64, 65-171A, 68-68A, 74-114 and 118-160 Titirangi Road, 2 Margan Avenue and 1 and 2 Northall Road, Titirangi
1454	Road widening purposes	1-23, 2, 24-34, 25-33, 37-47, 53-59, 63A-141, 64-186, 198-274, 273-347, 282-312, 318-320, 326-360, 351A-409, 370-386 and 390-400 West Coast Road, 69-71 Clayburn Road and 1 Pleasant Road, Glen Eden
1455	Road widening purposes	1-25, 12-40, 37,47-55A, 52-54, 58, 78, 80A-82, 86-88, 92-94 Swanson Road, Henderson
1456	Pedestrian mall	Pearn Crescent, Northcote
1457	Public off-street parking ...	32 College Road, Northcote
1458	Public off-street parking ...	76 Swanson Road, Henderson
1459	Public off-street parking ...	2 Fenwick Avenue, Milford
1461	Public off-street parking ...	12 Channel View Road, Takapuna

1462	Public off-street parking ...	R78 Hurstmere Road, Takapuna
1463	Public off-street parking ...	20 Clarence Street, Devonport
1464	Public off-street parking ...	5 Trading Place, Henderson
1465	Public off-street parking ...	85 Hurstmere Road, Takapuna
1466	Public off-street parking ...	41 Glenmall Road, Glen Eden
1467	Road widening	Hobsonville Road, Hobsonville
1468	Road widening	State Highway 16 (Westgate to Whenuapai)
1469	Road widening and improvement works.	Albany Highway, Albany
1470	The construction, operation and maintenance of a new road and improvements to the existing Gills Road.	Between Gills Road, Albany (south of Living Stream Road) to Oteha Valley Road (opposite Appian Way), from south of Living Stream Road along Gills Road to east of Lucas Creek bridge.
1471	Roading purposes	Between Mansel Drive and Falls Road, Warkworth.
1472	Withdrawn	
1473	Roading purposes	Land between Northside Drive West, Massey North and Trig Road, Whenuapai
1474	Construction, operation and maintenance of a new road link and associated wetland and improvements to the existing Glenvar Road.	Glenvar Ridge Road, Long Bay
1476	Road – Medallion Drive Link	56 Fairview Avenue, Albany
1477	Road widening and improvement works.	Lincoln Road, Henderson
1478	Road – Matakana Road Link	State Highway 1 to Matakana Road, Warkworth
1479	Construction, operation and maintenance of a road, cycleways, pedestrian paths and associated infrastructure.	<p>Land from Argent Lane roundabout at the intersection with Old Pine Valley Road south through the properties of 10 and 36 Old Pine Valley Road, tying into the existing Pine Valley Road to the north of the property boundary with 1731 Dairy Flat Highway:</p> <ul style="list-style-type: none"> • 10 Old Pine Valley Road (Sec 7 SO 315843, Sec 8 SO 315843, Pt Lot 5 DP 136559) • 36 Old Pine Valley Road (Lot 6 DP 136559) • The public road reserve between the parcels of land that form 10 Old Pine Valley Road.

1480	Construction, operation and maintenance of a partially realigned and upgraded arterial road between Old Pine Valley Road and the Silverdale Motorway Interchange.	<p>Dairy Flat Highway from the edge of the Northern Motorway northbound Silverdale off-ramp to the intersection of Dairy Flat Highway and Pine Valley Road, continuing up Pine Valley Road to the northern property boundary of 1731 Dairy Flat Highway:</p> <ul style="list-style-type: none"> • 1687 Dairy Flat Highway (Lot 1 DP 131154) • 1700 Dairy Flat Highway (Pt Lot 1 DP 68886) • 1731 Dairy Flat Highway (Sec 5 SO 315843, Sec 6 SO 315843, Pt Lot 1 DP 101886) • 1732 Dairy Flat Highway (Pt Lot 2 DP 68886) • Sec 6 SO 308591, Dairy Flat Highway • 36 Old Pine Valley Road (Lot 6 DP 136559)
------	---	--

Designation Schedule - Auckland Transport (3/3)

South

Number	Description	Location
1800	Lapsed	
1801	Lapsed	
1802	Road widening	128 Ormiston Road, Flat Bush
1804	Public off-street parking ...	143 Pakuranga Road, Pakuranga
1805	Car park and service lane	20 and 24 Uxbridge Road, Howick
1806	Road widening	109 and 129 Beachlands Road, 373, 460, 465, 469, 482, 492, 509, 529, 533, 600, 601-605, 639, 645-651, 650, 691, 702, 712, 722, 732, 746, 751, 758, 770, 781, 824, 830, 855, 865-867 and 897 Whitford-Maraetai Road and 49 and 110A Jack Lachlan Drive, Whitford (Stages 5, 6 and 7)
1807	New road (Whitford Bypass)	40, 51, 54, 58, 83, 133, 172, 173, 201, 227, 231, 230, 232, 238, 250, 257, 284, 330, 371, 374, 376 and 385 Whitford Park Road, 2, 21, 35, 91, 97, 101 and 401 Trig Road, 18, 24 and 30 Saleyard Road, 500 Brookby Road, 53 Polo Lane, 1 and 2 Turanga Road, 49 Clifton Road and 46, 53R, 104R, 109, 130, 150, 186, 299, 373 and 404 Whitford-Maraetai Road (Stages 1, 2, 3 and 4)
1808	Road widening	Ormiston Road and Chapel Road, Flat Bush
1809	Road widening	2, 5, 17, 22-38, 47-59, 56-60 and 67 Allens Road, 3-9 Smales Road, 1 and 2 Harris Road, 2 Ross Reid Place and 61 Sir William Avenue, East Tamaki
1810	Car parking asset	24 Hall St, Pukekohe
1811	Public off-street parking ...	27 Moore Street, Howick
1812	Public off-street parking ...	4 Tobin Street, Pukekohe
1813	Public off-street parking ...	21 Wallace Road, Papatoetoe
1814	Withdrawn	
1815	Withdrawn	
1816	Public off-street parking ...	27 Charles Street, Papatotetoe
1817	Public off-street parking ...	2 Davies Avenue, Manukau
1818	Withdrawn	
1819	Public off-street parking ...	41 Moore Street (Fencible Drive), Howick
1820	Public off-street parking ...	1-13 Maich Road, Papakura
1821	Public off-street parking ...	26-32 O'Shannessy Street, Papakura
1822	Public off-street parking ...	8 Davies Avenue, Manukau
1823	Public off-street parking ...	37 Coles Crescent, Papakura
1824	Public off-street parking ...	15 Eric Baker Place, Papatotetoe
1825	Withdrawn	

1826	Public off-street parking ...	1R Newbury Street, Otara
1827	Public off-street parking ...	21 Shirley Road, Papatoetoe
1828	Public off-street parking ...	9 Wellington Street (Picton Street), Howick
1829	Public off-street parking ...	7 Massey Avenue, Pukekohe
1830	Public off-street parking ...	4 Wellington Street, Howick
1831	Public off-street parking ...	1-49 Waddon Place and 121 Bader Drive, Mangere
1832	Public off-street parking ...	Constable Road (corner King Street), Waiuku
1833	Road widening	Flat Bush School Road and Murphys Road, Flat Bush
1834	Road widening	21 and 39 Flat Bush School Road and 66 Thomas Road, Flat Bush
1835	Upgrade intersection at East Tamaki, Ormiston and Preston Roads in Otara	267Z, 279, 279A, 279B, 279C, 279D, 279E, 279F, 279G, 279H, 279I, 283, 285 and 287 East Tamaki Road, 2, 4, 6, 1/6, 2/6, 3/6, 4/6, 5/6, 6/6, 7/6, 8/6 and 8 Ormiston Road and 208, 208A and 243 Preston Road
1836	The purpose of the designation is to enable the Requiring Authority to widen and upgrade the Redoubt Road-Mill Road Corridor. The public works are required in order to provide future corridor capacity to support growth identified within the Takanini and wider southern area and provide an alternate north/south corridor to State Highway 1.	Parts of Redoubt Road, Mill

Attachment 4: GIS Viewer

BEFORE



 Designation

AFTER



Whilst due care has been taken, Auckland Council gives no warranty as to the accuracy and completeness of any information on this map/plan and accepts no liability for any error, omission or use of the information.

Date: 8/02/2022

Remove Designation ID1403
55 – 67 and 76 – 90 Red Beach Road, Whangaparaoa



Plans and Places

BEFORE

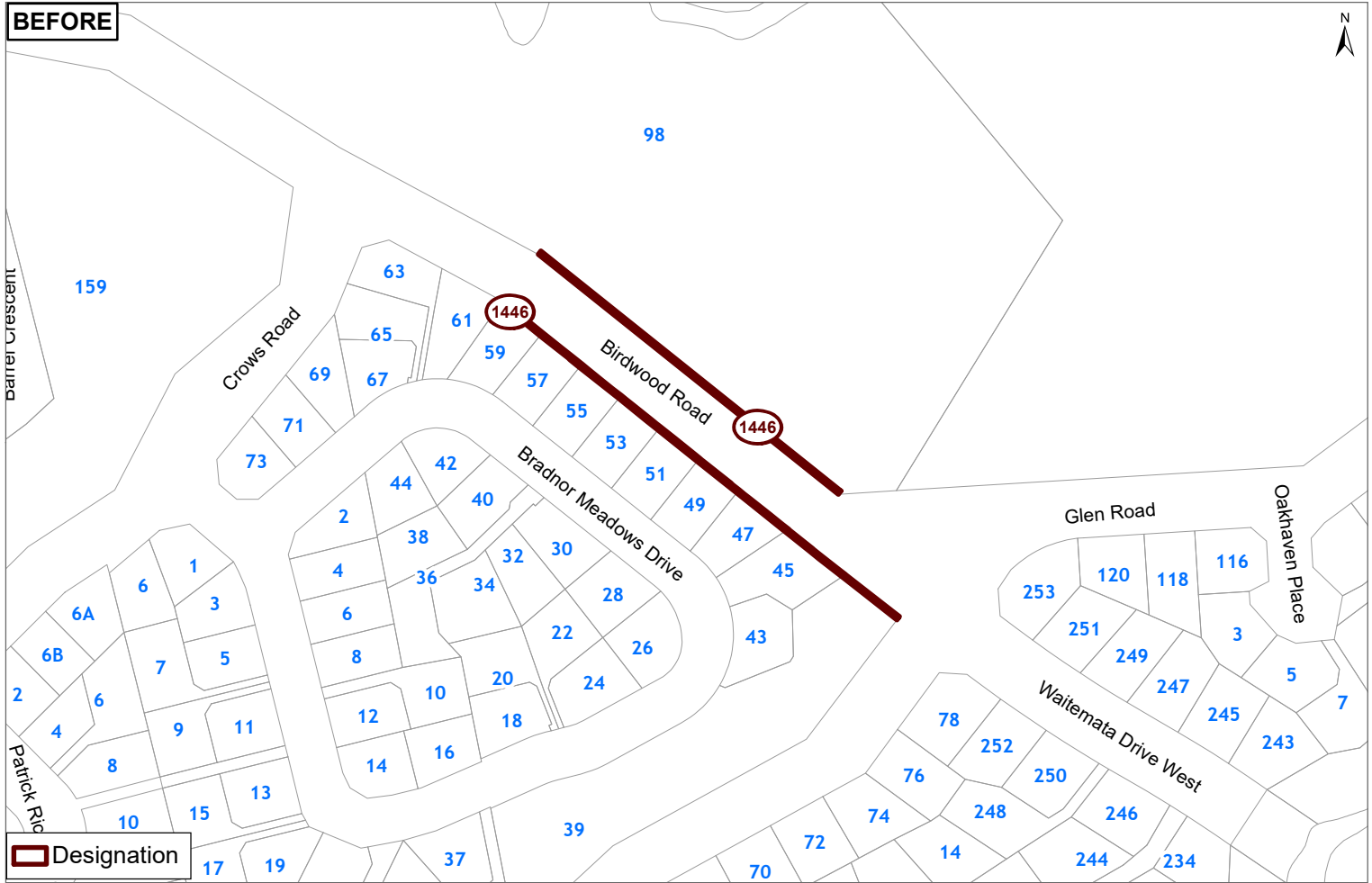

AFTER

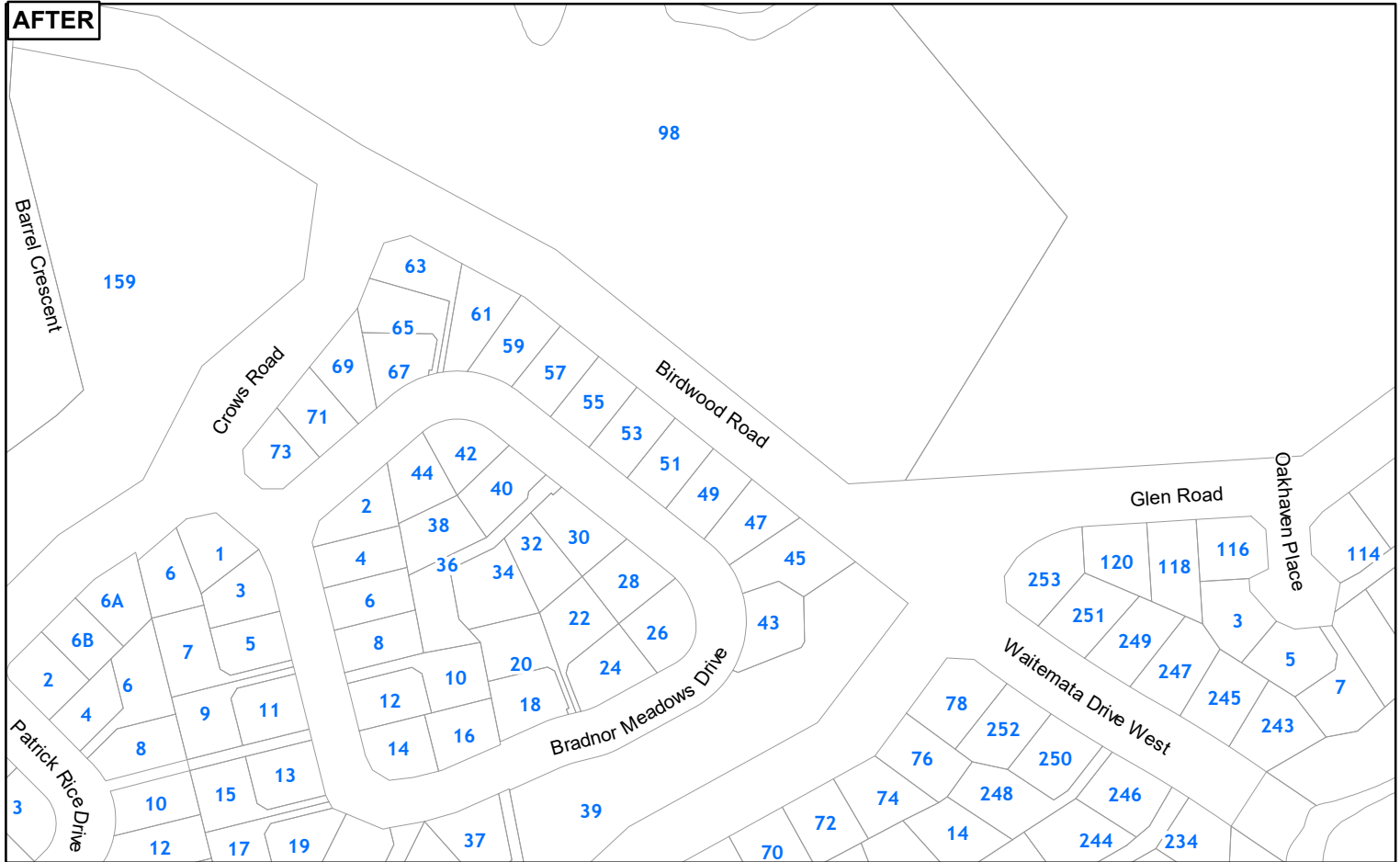

Whilst due care has been taken, Auckland Council gives no warranty as to the accuracy and completeness of any information on this map/plan and accepts no liability for any error, omission or use of the information.

Date: 9/02/2022

**Remove Designation ID1446
39 – 59 Bradnor Meadows Drive and
98 Birdwood Road**



Plans and Places

BEFORE

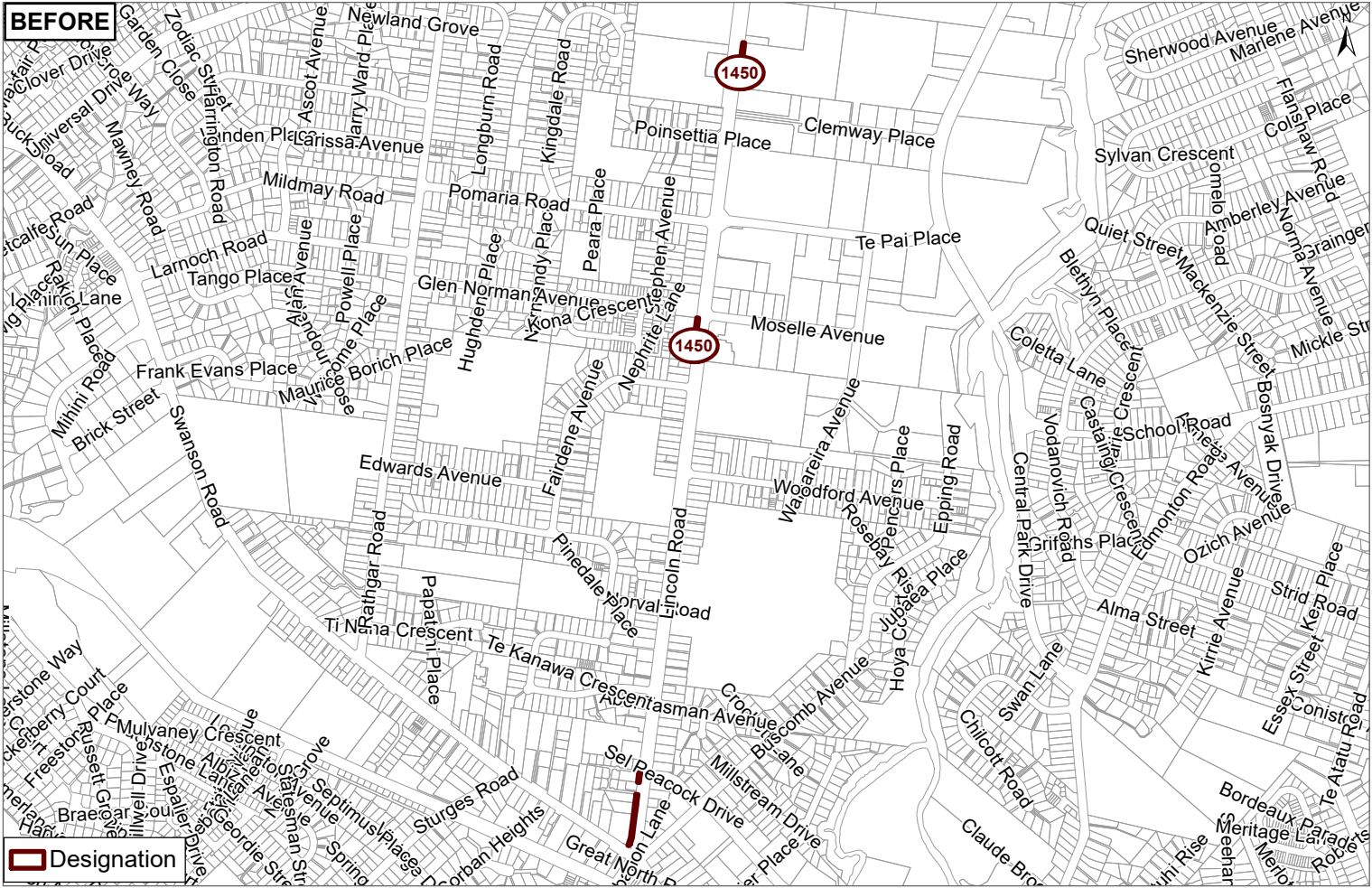

AFTER

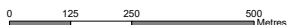
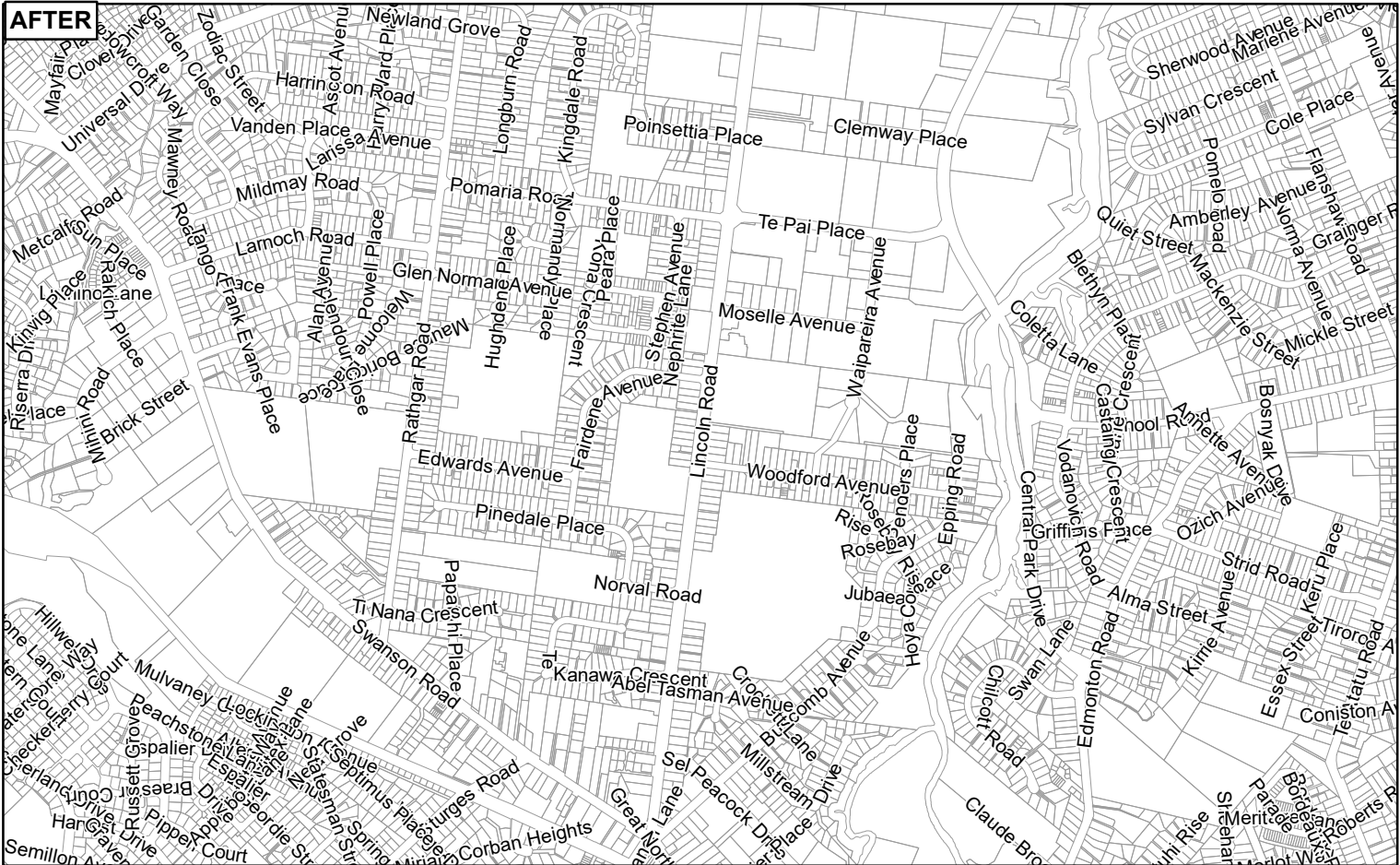

Whilst due care has been taken, Auckland Council gives no warranty as to the accuracy and completeness of any information on this map/plan and accepts no liability for any error, omission or use of the information.

Date: 8/02/2022

Remove Designation ID1450
6 – 8, 14, 122 – 134, 211 – 221 Lincoln Road
and 1 -3 Swanson Road, Henderson



Plans and Places

BEFORE

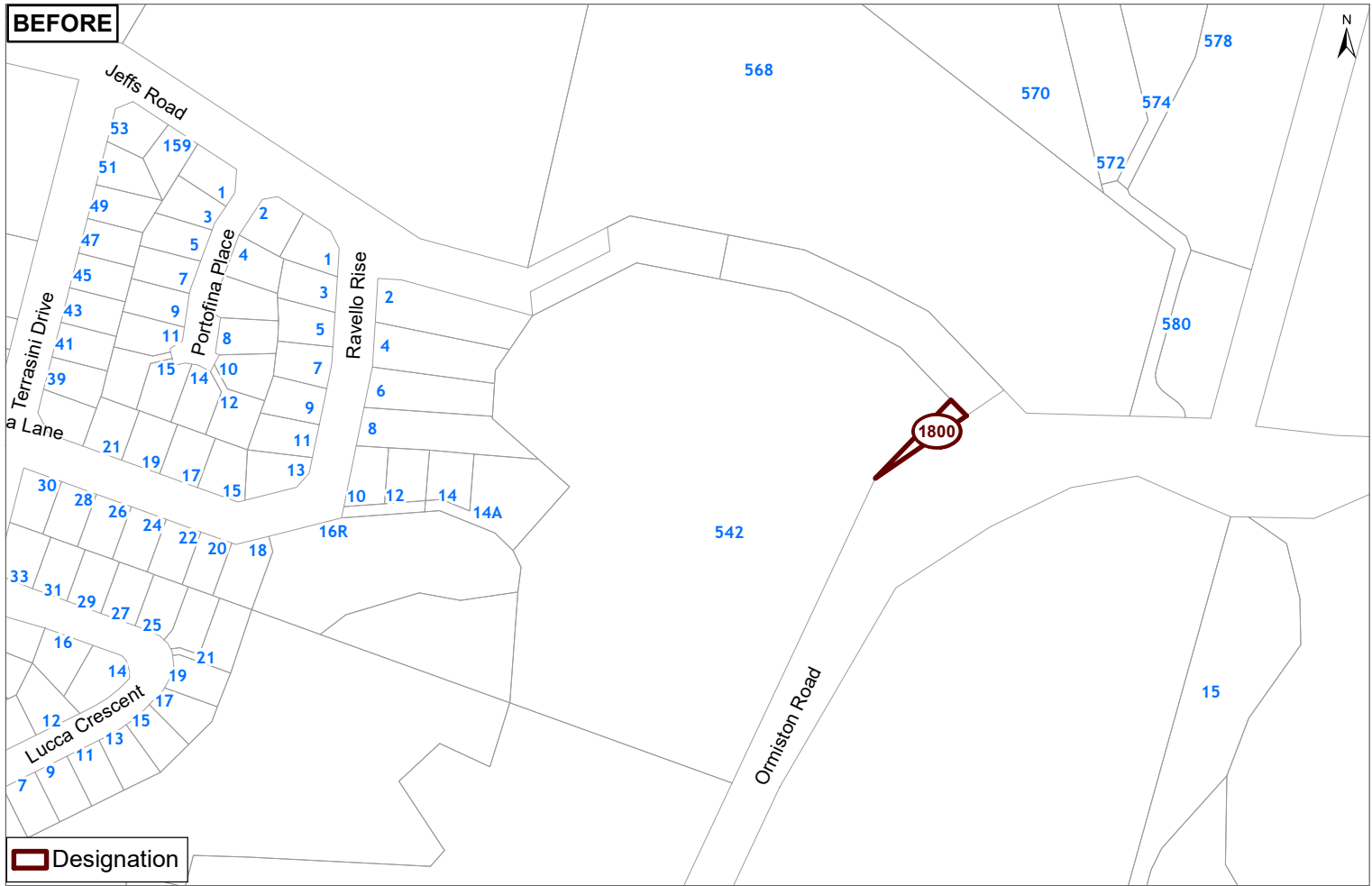

AFTER

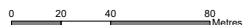
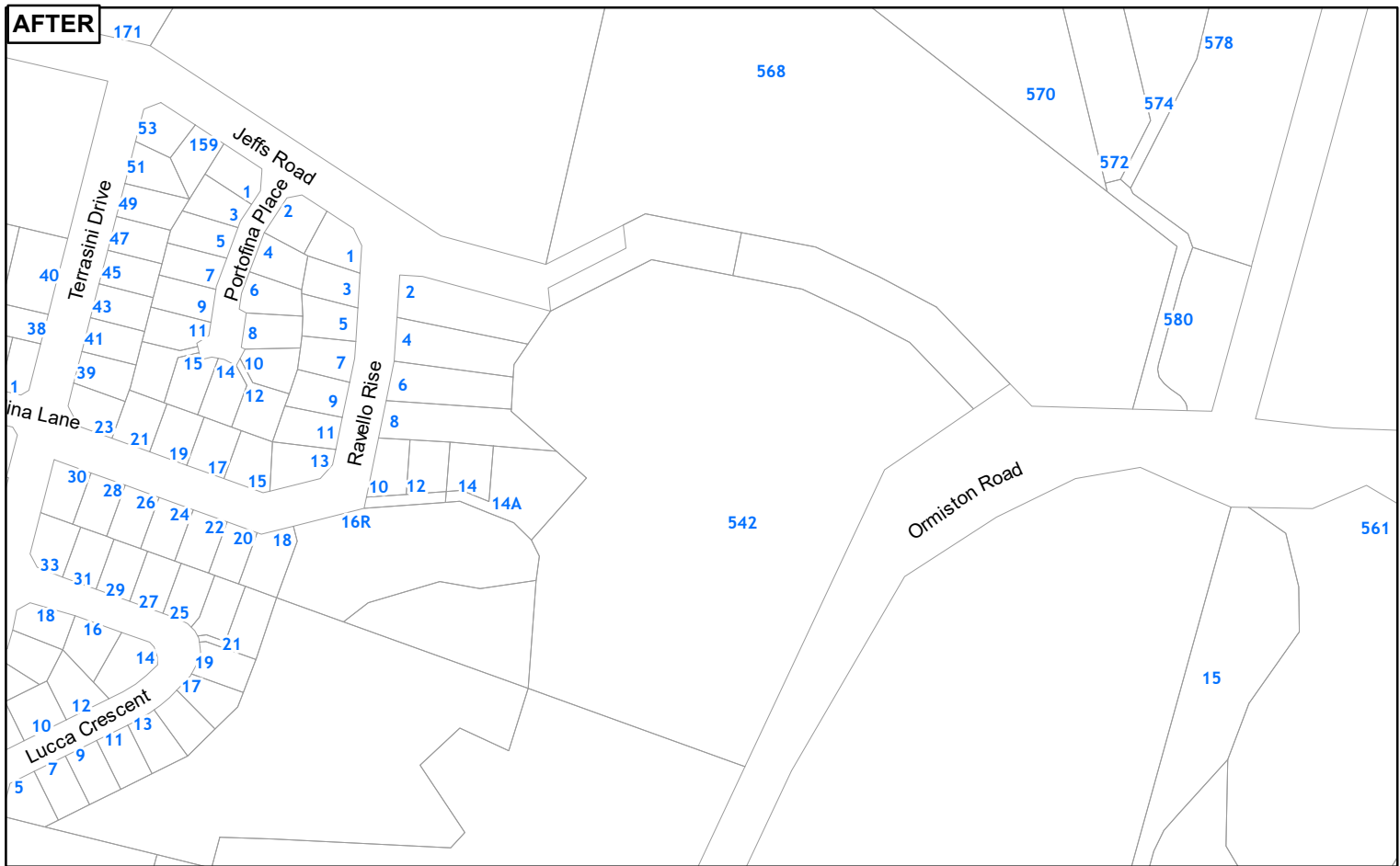

Whilst due care has been taken, Auckland Council gives no warranty as to the accuracy and completeness of any information on this map/plan and accepts no liability for any error, omission or use of the information.

Date: 8/02/2022

Remove Designation ID1800 542 and 568 Ormiston Road, Flat Bush



Plans and Places

BEFORE

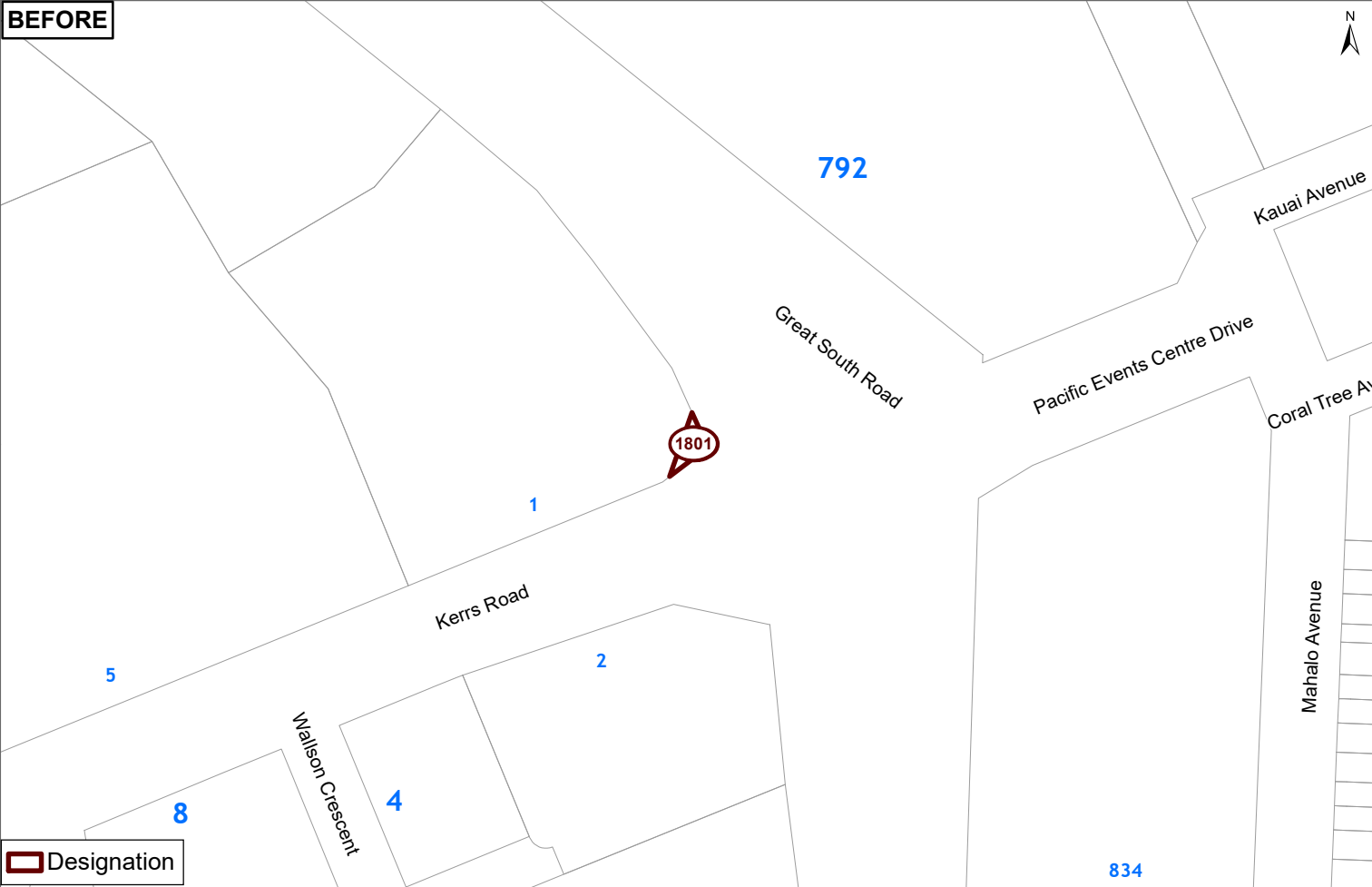

AFTER

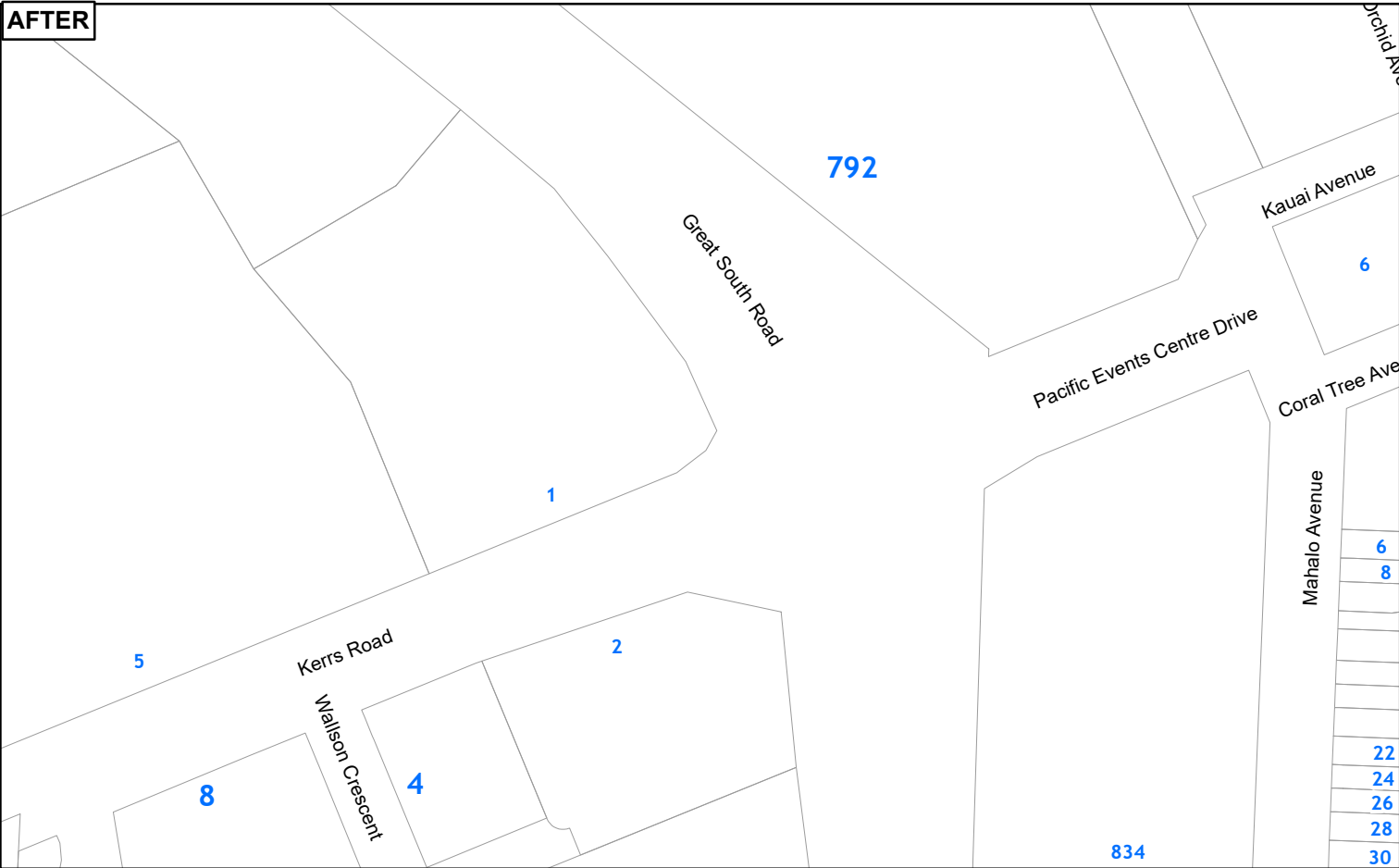

Whilst due care has been taken, Auckland Council gives no warranty as to the accuracy and completeness of any information on this map/plan and accepts no liability for any error, omission or use of the information.

Date: 8/02/2022

Remove Designation ID1801 1 Kerr Road, Manukau City Centre



Plans and Places